

## Helmos Hellenic Atmospheric Aerosol and Climate Change station

Some photos from Helmos Hellenic Atmospheric Aerosol and Climate Change station (HAC<sup>2</sup>), working instruments and facilities. First outside, then inside, instruments and systems.



HAC<sup>2</sup> 1. Northern and eastern view of the station.



HAC<sup>2</sup> 2. Western - southern and eastern - northern view of the station.



HAC<sup>2</sup> 3. View of the Heated inlets working in snow and during the installation.

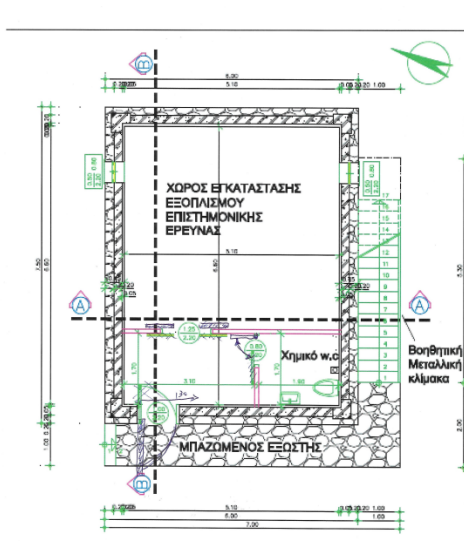

HAC<sup>2</sup> 4. Design of the building and general view of the main room during the installation of the instruments.



## Line 1



Line 1. 1. Line 1 is the inlet of SMPS, OPC (and Athalometer to be installed). The first photo taken from the entrance s view from all the parts of the SMPS and line 1 PM10 head inlet and 3 line nozzles for every instrument. Also three dryers are used one for every instrument, the size corresponding to the flow

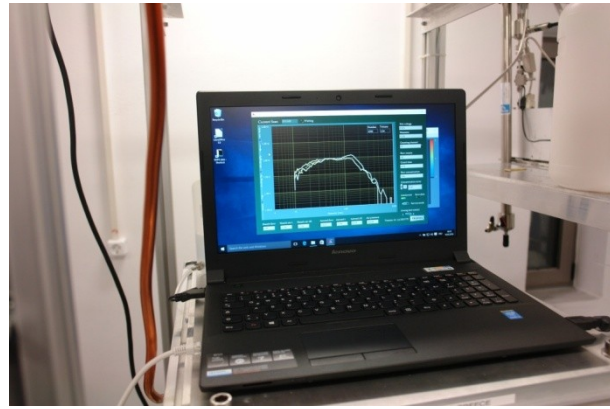
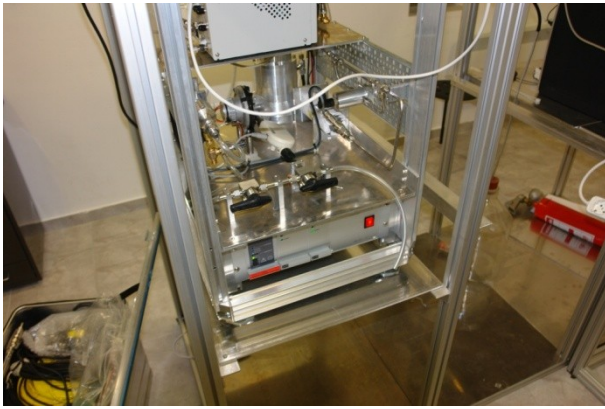

SMPS Laptop of the instrument while the instrument is running, this screen has a size distribution of aerosols from the TROPOS software.

## Line 2





Line 2 The Digital sampler

### Line 3



Line 3. Inlet for the three instruments, nephelometer, O<sub>3</sub> monitor and Picarro.